

OPW 2173AVN

The OPW 2173AVN Vapor Recovery Dry Disconnect Coupling provides for easy access in recovering vapors for either top or bottom loading/unloading tank truck operations.

The OPW 2173AVN installs onto the QRB valve on tank trailers and can provide a dry disconnect connection for emergency evacuation of hazardous liquids in the case of roll-over.

Benefits

- **Closed-Loop Protection** – Helps protect people and the environment by providing a vapor and liquid tight seal during the connection/disconnection process specifically designed to contain VOC (Volatile Organic Compounds) products that have high vapor pressure that evaporates quickly. Contains fugitive emissions and transfers VOC's without vapor loss.
- **Roll-Over Safety** – Its low profile design keeps the fitting below roll-over plane to minimize damage in the event of a roll-over. Meets IMO profile dimensions.
- **Easy Emergency Evacuation** – Provides a dry disconnect connection for emergency evacuation of hazardous liquids in case of roll-over.
- **Quick and Easy Cleaning** – Designed for easy disassembly for routine cleaning.

Features

- **Vapor Hose Connection** – 2" Kamvalok® Dry Disconnect or D2000™ Actuating Couplers.
- **No trailer modifications required** – Easy attachment to existing MC307, DOT407, MC312, and DOT412 trailers.
- **3" straight thread mounting** with 2" dry disconnect cam and groove connection makes the ideal 3" x 2" adaptor for QRB valves.

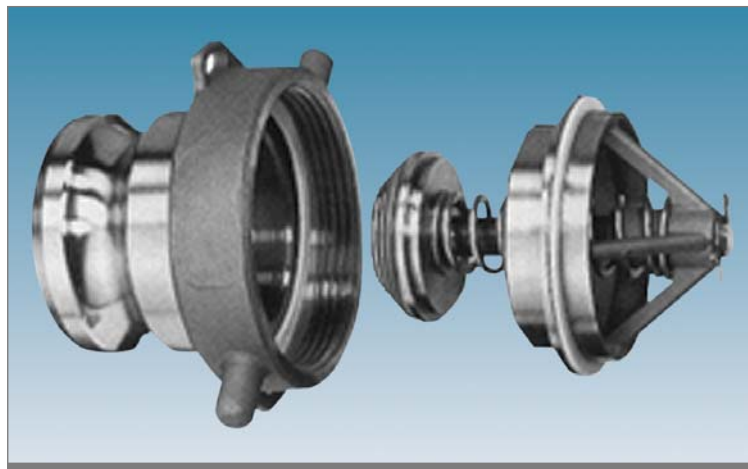

OPW's 2173AVN Dry Disconnect Coupling installs on the QRB valve on the truck

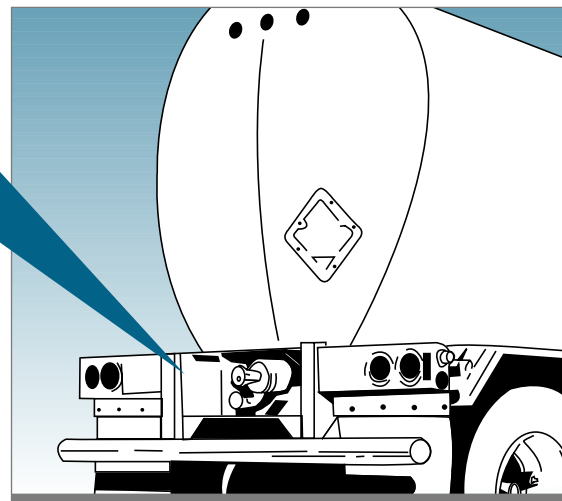

1004D2 API Coupler

The OPW Engineered Systems 1004D2 is the standard in "drip-less" bottom loading couplers and a proven performer. The 1004D2 mates with all 4" bottom loading adaptors built in accordance with API RP-1004 requirements to significantly reduce liquid loss.

Benefits

- **Designed to effectively handle all fuels** – high performance Viton® seals are standard, providing excellent wear and fuel resistance. Other seals including Buna-N, Teflon®, Chemraz®, and Kalrez® are available.
- **Designed for "less mess" at your loading rack** – the new, easy self-aligning 5-Cam design ensures a tight connection to the adaptor and resists side forces.
- **Eliminates risk of nose seal "blow out"** – beveled for superior sealing.
- **Seal Kits** – include everything needed to change out all seals in the 1004D2 Bottom Loading Coupler. Available in high-performance Viton®, Buna-N and other seal materials.
- **Conversion Kits** - available to convert a 1004 to a 1004D2. Includes poppet, cylinder and beveled nose seal, shaft seal, cylinder seal and other items included in all OPW coupler repair kits. High performance Viton® or Buna-N.

